

ENTTEC CVC3 (Pixel Link)

3 CHANNEL AUTO ADDRESSING CONSTANT VOLTAGE LED STRIP CONTROLLER

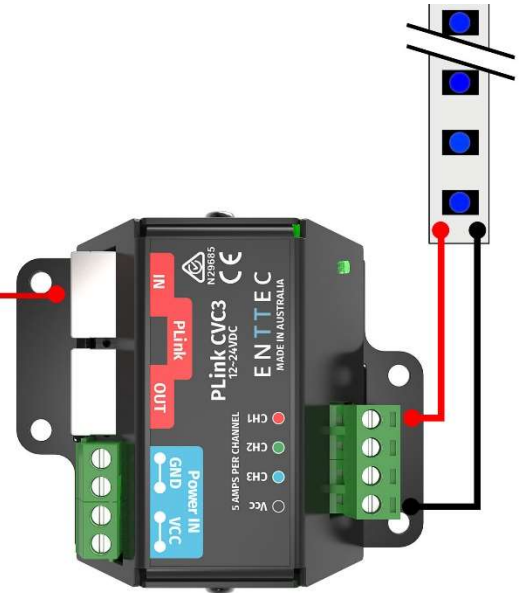

PLink
PIXEL LINK



Features

- CVC3 Supports standard RGB Tape such as ENTTEC 9VL4
- Each CVC3 unit can control 3 dimmable channels of LED tape (either RGB or three individual single colour strips).
- Each PLink run can be used to individually control up to 340 RGB LED strips or 1024 single colour LED strips (2 DMX universes).
- Incremental automatic addressing of each unit allows for a versatile and quick configuration for both large and small products.
- PLink accessories are compatible with both the ENTTEC PIXIE DRIVER and PIXELATOR.
- Requires an external DC power supply.
- Data extensions up to 300 meters over Cat5/Cat5e/Cat6 cable
- Small, light and easy to hide design
- Scalable design for large projects
- Ideal for custom shape pixel LED installations
- High power screw terminal connectors
- Easy wiring using standard Cat5/Cat6 connections
- Simple installation.

Specifications

Item	CVC3	
Input Voltage	12-24VDC	
Maximum Total Output Power	12 V	120 w
	24 V	240 w
Maximum Output Current Per Pin (Screw Terminal)	5 Amp per channel	
Data Input	WS2812b (from the Pixelator System)	
Data Output Protocol	PLINK	
Data Refresh Rate	400Hz	
Data Output Capability Per PLink Port	340 RGB Pixels 1020 DMX channels (~2 Universes)	
Operating Temperature	-10° to 65° C	
Protection Rating	IP20	

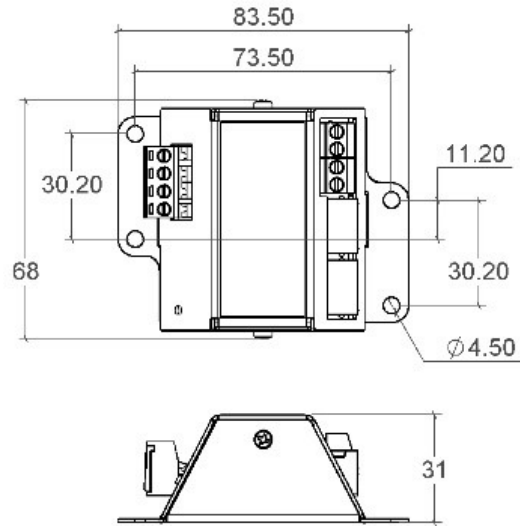

Safety

- Never plug PLink ports into Ethernet outlets
- Do not remove covers, there are no serviceable parts inside
- Make all the connections before you plug in the main power supply
- Do not exceed the ratings of the device.

Ordering Information

PN	Description
73920	CVC3 (12-24V)

Mechanical

Notes:

- Locate the power supply to the pixel link (plink) device as close as possible (recommended 1 to 2 metres)
- Plink system only works with CAT5/6 straight-through cables, do not use crossover cables.
- Maximum recommended distance between output of CVC3 and tape is 3m
- Maximum recommended data extensions are 300 meters over Cat6 cable between CVC3 devices.

LED TAPE APPLICATION DIAGRAMS

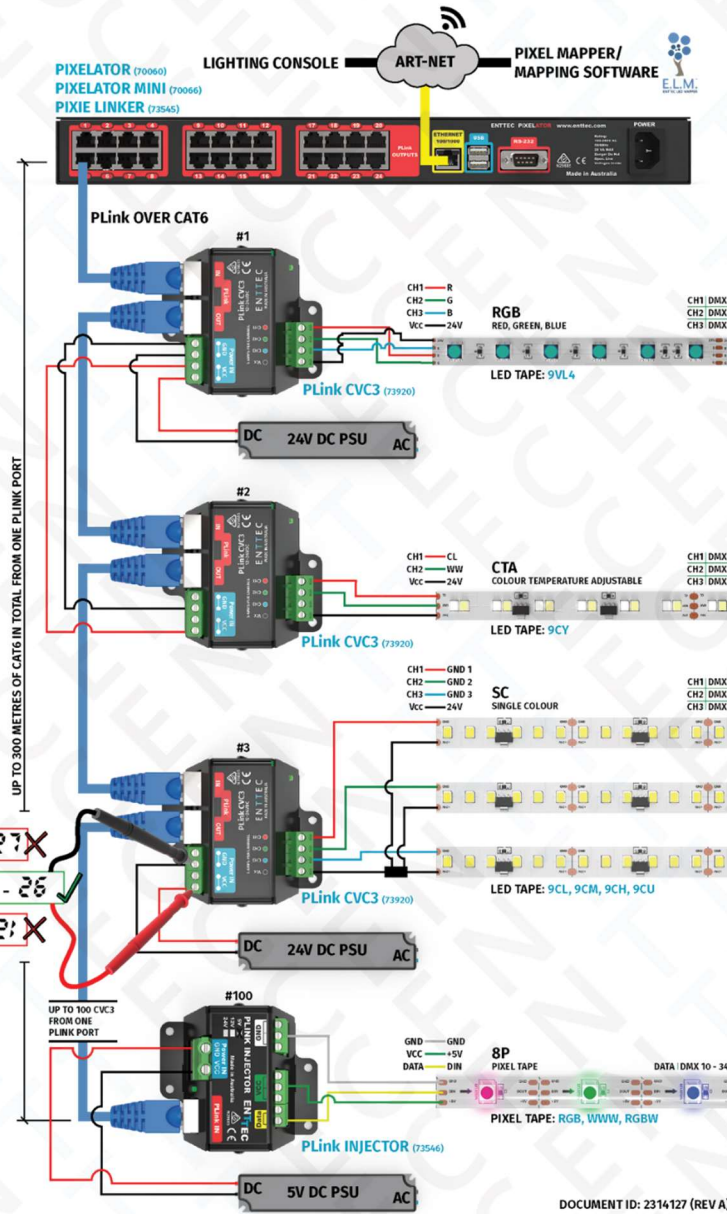

enttec.com

MELBOURNE AUS / LONDON UK / RALEIGH-DURHAM USA